

28 & 28
TRANSMITTER DIST.

CHECK

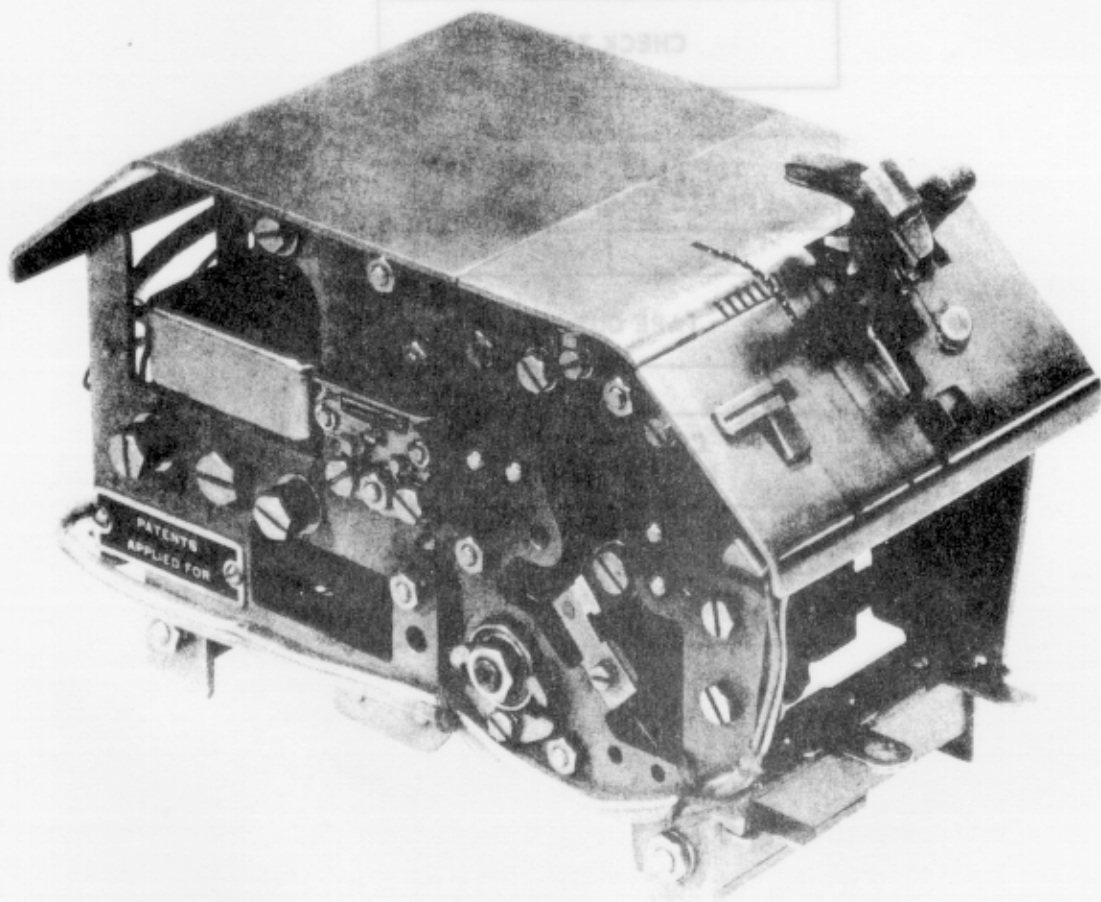

**28 & 35
TRANSMITTER DIST.**

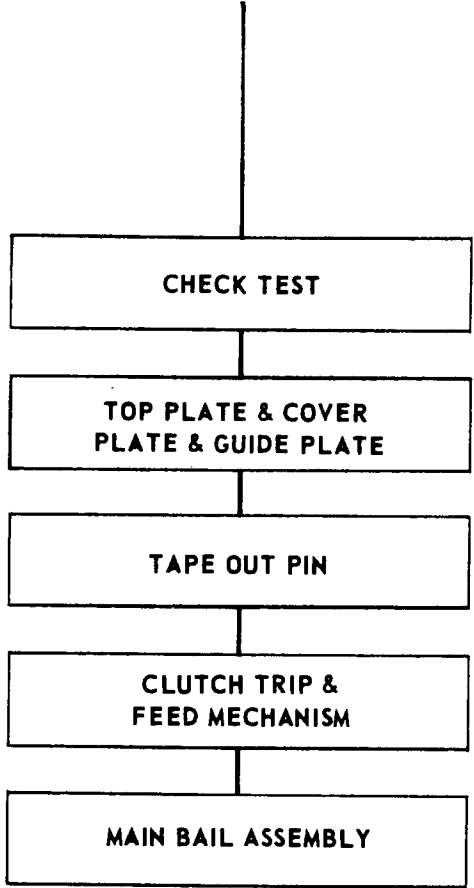

REQUIREMENTS ----

1. MATING EDGE OF TOP PLATE SHOULD BE FLUSH TO 0.003 INCH UNDER FLUSH EDGE OF TAPE GUIDE PLATE (WITHIN AREA OF TAPE LID) WHEN PLATE ENGAGES AT LEAST 3 PROJECTIONS
2. FEEDWHEEL SLOT SHOULD ALIGN WITH SLOT IN TAPE GUIDE PLATE SO THAT FEED WHEEL ROTATES FREELY WITH DETENTS AND FEED PAWL DISENGAGED (FREEWHEELING)
3. CLEARANCE BETWEEN PROJECTION OF TAPE LID AND TOP PLATE (TAPE LID LATCHED) MIN. 0.010 IN. --- MAX. 0.020 AT CURVED PORTION: MIN. 0.010 --- MAX. 0.025 AT FLAT PORTION.

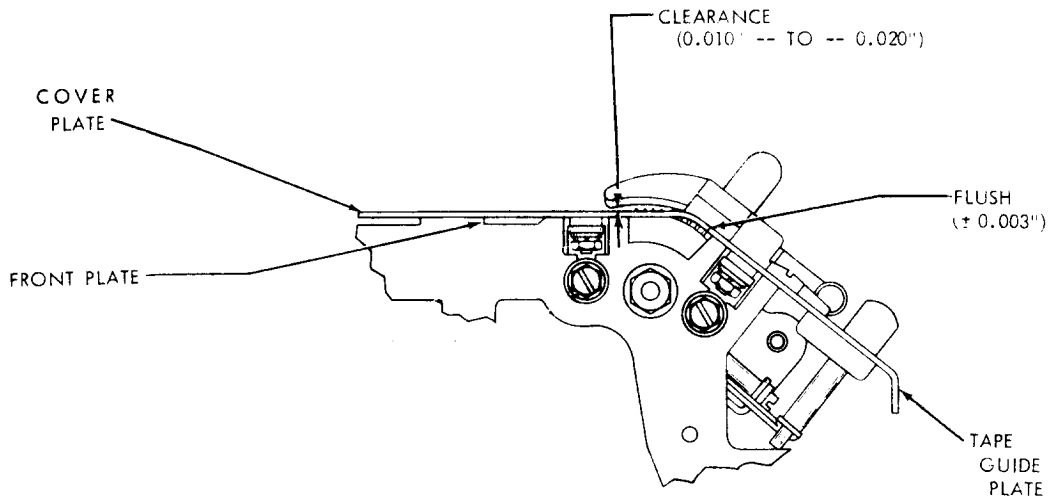

TAPE LID ASSEMBLY

TAPE LID FRONT BEARING SURFACE SHOULD TOUCH TAPE GUIDE PLATE. CLEARANCE MEASURED AT FIN OF TAPE LID WHICH IS IN LINE WITH REAR TAPE GUIDE MIN. 0.010 INCH --- MAX. 0.018 INCH

NOTE 1 -- WHEN BOTH PLATES ARE ASSEMBLED ON UNIT, LEFT EDGE OF LID MAY TOUCH TOP PLATE AND SOME CHANGE IN THIS CLEARANCE MAY BE EXPECTED.

RELEASE PLUNGER SHOULD HAVE SOME END PLAY WHEN LID IS LATCHED AGAINST TAPE GUIDE PLATE.

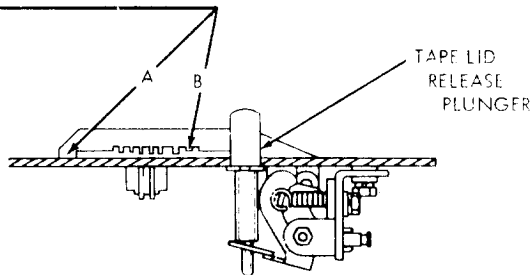

To Adjust:

28 Type B. S. P. 573-127-703

35 Type B. S. P. 574-225-700

TAPE OUT SENSING PIN

REQUIREMENTS

WITH START-STOP LEVER IN FREE WHEELING OR STOP POSITION, TIP OF TAPE OUT PIN SHOULD BE FLUSH TO 0.010 INCH BELOW TOP SURFACE OF TAPE GUIDE PLATE.

WITH START-STOP LEVER IN RUN POSITION, CLEARANCE AS SHOWN SHOULD BE AT LEAST 0.055 INCH.

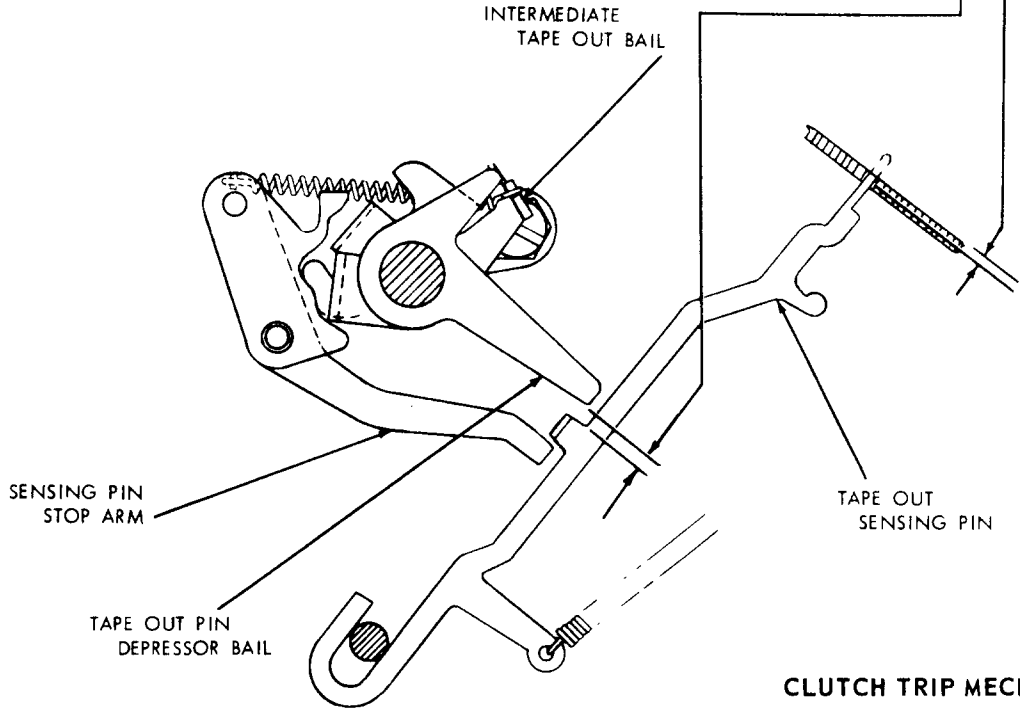

CLUTCH TRIP MECHANISM

CLUTCH TRIP LEVER

REQUIREMENTS--(REMOVE COVER PLATE)
 WITH CLUTCH DISK STOP LUG OPPOSITE CLUTCH TRIP LEVER, CLEARANCE BETWEEN INNER SURFACE OF LUG AND LEVER PLAY TAKEN UP TO MAKE CLEARANCE MAX.
 MIN. 0.012 INCH — MAX. 0.025 INCH

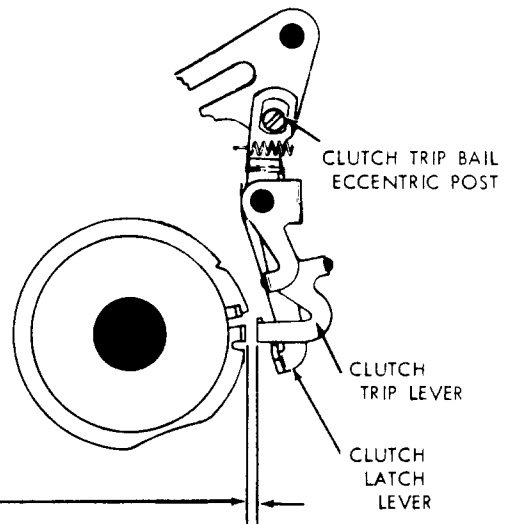

To Adjust:

- 28 Type B. S. P. 573-127-703
- 35 Type B. S. P. 574-225-700

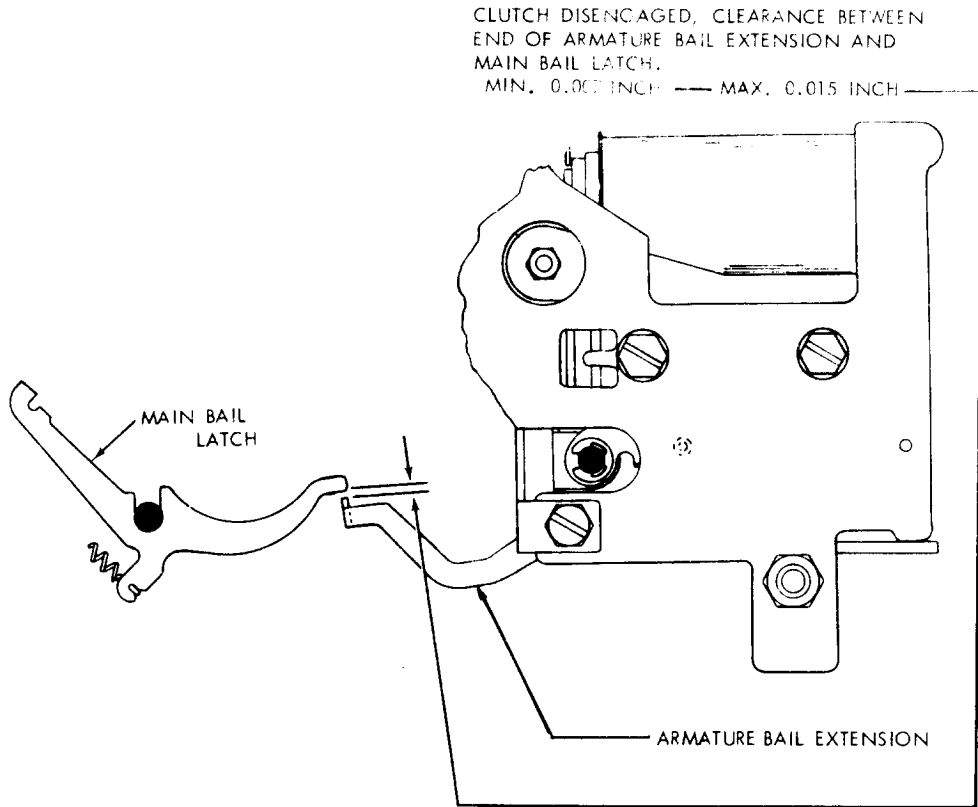

FEED PAWL MECHANISM

FEED PAWL

REQUIREMENT----(TOP PLATE REMOVED) - WITH HIGH PART OF ECCENTRIC TOWARD THE RIGHT
AND SENSING FINGERS IN THEIR LOWERMOST POSITION, CLEARANCE BETWEEN FEED PAWL
AND RATCHET TOOTH JUST ENGAGED.
SOME _____ TO _____ 0.003 INCH

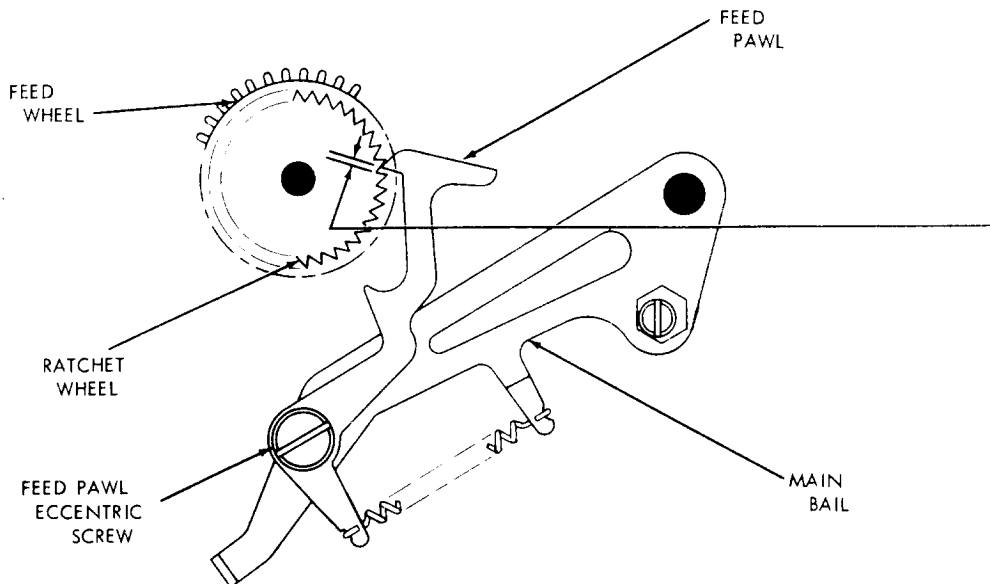

To Adjust:

28 Type B. S. P. 573-127-703

35 Type B. S. P. 574-225-700

MAIN BAIL ASSEMBLY

MAIN BAIL

REQUIREMENT----(TOP PLATE REPLACED)
 WITH CODE SENSING PINS IN LOWER-
 MOST POSITION, CLEARANCE BETWEEN
 TIP OF HIGHEST SENSING PIN AND
 TOP SURFACE OF TAPE GUIDE PLATE.
 MIN. 0.010 INCH — MAX. 0.020 INCH

MAIN BAIL TRIP LEVER

REQUIREMENT----(TOP PLATE REPLACED) - WITH CLUTCH DISENGAGED AND MAINSHAFT
 IN ITS STOP POSITION, TIP OF HIGHEST SENSING FINGER SHOULD BE FLUSH
 TO _____ 0.005 INCH BELOW TOP SURFACE OF TAPE GUIDE PLATE.

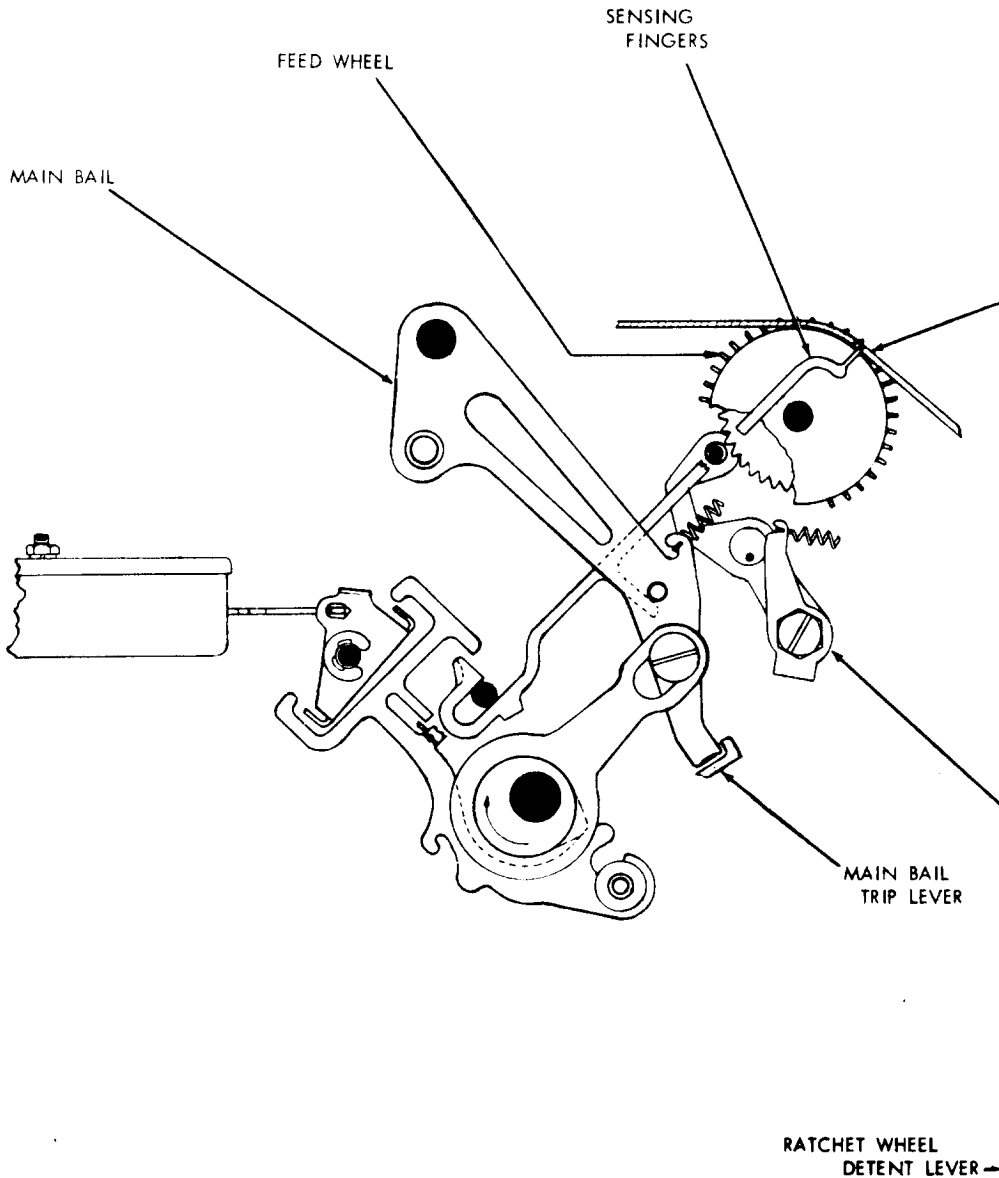
**To Adjust:**

28 Type B. S. P. 573-127-703

35 Type B. S. P. 574-225-700